

# PLUS Talking

Blood Glucose Monitoring System

---

## Owner's Manual

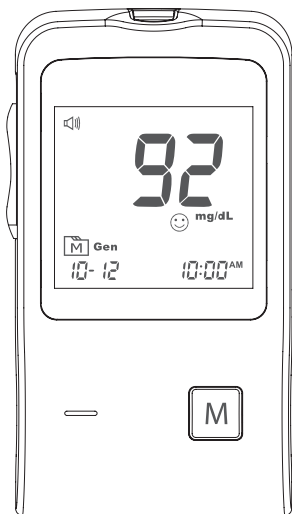



# Dear PLUS Talking System Owner:

Thank you for purchasing the **PLUS Talking** Blood Glucose Monitoring System. This manual provides important information to help you to use the system properly. Before using this product, please read the following contents thoroughly and carefully.

Regular monitoring of your blood glucose levels can help you and your doctor gain better control of your diabetes. Due to its compact size and easy operation, you can use the **PLUS Talking** Blood Glucose Monitoring System to easily monitor your blood glucose levels by yourself anywhere, any time.

If you have other questions regarding this product, please contact the local customer service or place of purchase.

# IMPORTANT SAFTY INSTRUCTIONS READ BEFORE USE

1. Use this device **ONLY** for the intended use described in this manual.
2. Do **NOT** use accessories which are not specified by the manufacturer.
3. Do **NOT** use the device if it is not working properly or if it is damaged.
4. Do **NOT** use the equipment in places where aerosol sprays are being used or where oxygen is being administered.
5. Do **NOT** under any circumstances use the device on newborns or infants.
6. This device does **NOT** serve as a cure for any symptoms or diseases. The data measured is for reference only. Always consult your doctor to have the results interpreted.
7. Before using this device to test blood glucose, read all instructions thoroughly and practice the test. Carry out all the quality control checks as directed.
8. Keep the device and testing equipment away from young children. Small items such as the battery cover, batteries, test strips, lancets and vial caps are choking hazards.
9. Use of this instrument in a dry environment, especially if synthetic materials are present (synthetic clothing, carpets etc.) may cause damaging static discharges that may cause erroneous results.

10. Do **NOT** use this instrument in close proximity to sources of strong electromagnetic radiation, as these may interfere with the accurate operation.
11. Proper maintenance and periodically control solution test are essential to the longevity of your device. If you are concerned about your accuracy of measurement, please contact the local customer service or place of purchase for help.

**KEEP THESE INSTRUCTIONS IN A SAFE PLACE**

# TABLE OF CONTENTS

<b>BEFORE YOU BEGIN</b>	<b>08</b>
Important Information	08
Intended Use	09
Test Principle	09
Meter Overview	10
Display Screen	11
The Four Main Functions of the Meter	12
Test Strip	13
<b>SETTING THE METER</b>	<b>14</b>
<b>THE FOUR MEASURING MODES</b>	<b>19</b>
<b>BEFORE TESTING</b>	<b>20</b>
Quality Control Testing	20
Performing a Control Solution Test	20
<b>TESTING WITH BLOOD SAMPLE</b>	<b>24</b>
Preparing the Lancing Device for Blood Testing	24
Preparing the Puncture Site	24
Performing a Blood Glucose Test	26
Alternative Site Testing	30
<b>METER MEMORY</b>	<b>31</b>
Reviewing Test Results	31
Reviewing Blood Glucose Day Average Results	32
<b>DOWNLOADING RESULTS ONTO A COMPUTER</b>	<b>33</b>

<b>MAINTENANCE</b>	<b>34</b>
Battery	34
Caring for Your Meter	36
Caring for Your Test Strips	37
Important Control Solution Information	38
<b>SYSTEM TROUBLESHOOTING</b>	<b>39</b>
Result Readings	39
Error Messages	40
Troubleshooting	41
<b>DETAILED INFORMATION</b>	<b>42</b>
<b>SYMBOL INFORMATION</b>	<b>43</b>
<b>SPECIFICATIONS</b>	<b>44</b>

# BEFORE YOU BEGIN

## Important Information

- Severe dehydration and excessive water loss may cause readings which are lower than actual values. If you believe you are suffering from severe dehydration, consult a healthcare professional immediately.
- If your blood glucose results are lower or higher than usual, and you do not have any symptoms of illness, first repeat the test. If you have symptoms or continue to get results which are higher or lower than usual, follow the treatment advice of your healthcare professional.
- Use only fresh whole blood samples to test your blood glucose. Using other substances will lead to incorrect results.
- If you are experiencing symptoms that are inconsistent with your blood glucose test results and you have followed all the instructions given in this owner's manual, contact your healthcare professional.
- We do not recommend using this product on severely hypotensive individuals or patients in shock. Please consult the healthcare professional before use.
- The measurement unit used for indicating the concentration of blood or plasma glucose can either have a weight dimension (mg/dL) or a molarity (mmol/L). The approximate calculation rule for conversion of mg/dL in mmol/L is:

mg/dL	Divided by 18	= mmol/L
mmol/L	Times 18	= mg/dL

For example:

1)  $120 \text{ mg/dL} \div 18 = 6.6 \text{ mmol/L}$

2)  $7.2 \text{ mmol/L} \times 18 = 129 \text{ mg/dL}$  approximately.



## Intended Use

This system is intended for use outside the body (*in vitro* diagnostic use) by people with diabetes at home and by health care professionals in clinical settings as an aid to monitoring the effectiveness of diabetes control. It is intended to be used for the quantitative measurement of glucose (sugar) in fresh whole blood samples (from the finger, palm, forearm and upper arm).

It should not be used for the diagnosis or screening of diabetes, or testing on newborns.

Professionals may test with capillary and venous blood sample; home use is limited to capillary whole blood testing.

**PLUS Talking** “speaks” aloud with step by step instructions to guide you through the process of blood glucose testing.

## Test Principle

Your system measures the amount of sugar (glucose) in whole blood. The glucose testing is based on the measurement of electrical current generated by the reaction of glucose with the reagent of the strip. The meter measures the current, calculates the blood glucose level, and displays the result. The strength of the current produced by the reaction depends on the amount of glucose in the blood sample.

# Meter Overview

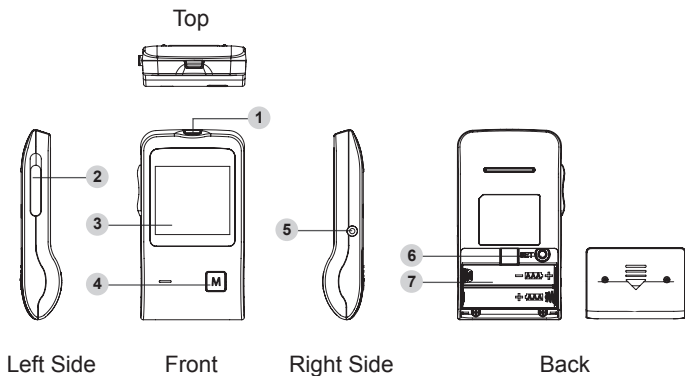

**1 Test Strip Slot**

Insert test strip here to turn the meter on for testing.

**2 Test Strip Ejector**

Eject the used strip by pushing up this button.

**3 Display Screen**

**4 M Button**

Enter the meter memory and silence a reminder alarm.

**5 Data Port**

Download test results with a cable connection.

**6 SET Button**

Enter and confirm the meter settings.

**7 Battery Compartment**



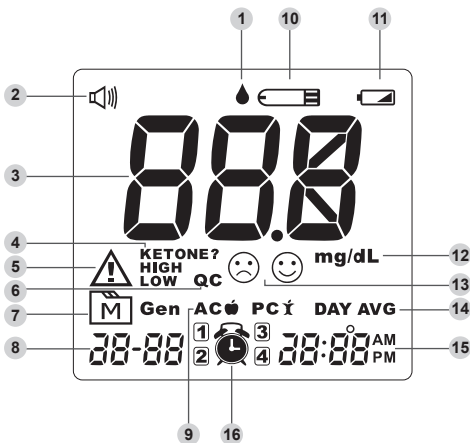

# Display Screen



- |                         |                         |
|-------------------------|-------------------------|
| 1 Blood Drop Symbol     | 9 Measuring Mode        |
| 2 Volume Symbol         | 10 Test Strip Symbol    |
| 3 Test Result           | 11 Low Battery Symbol   |
| 4 Ketone Warning        | 12 Measurement Unit     |
| 5 Error Warning         | 13 Face/Low/High Symbol |
| 6 Control Solution Mode | 14 Day Average          |
| 7 Memory Mode Symbol    | 15 Time                 |
| 8 Date                  | 16 Alarm Symbol         |

# The Four Main Functions of the Meter

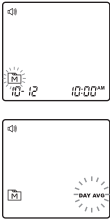
- 1) Setting Mode
- 2) Measuring Mode
- 3) Memory Mode
- 4) Communication Mode

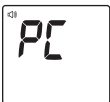
DISPLAY	MODE	HOW TO ENTER
	<p><b>Setting Mode:</b> Set up date, time and alarm.</p>	<p>With the meter off, press <b>SET</b> to enter the Setting Mode.</p>
	<p><b>Measuring Mode:</b> Perform your blood glucose tests.</p>	<p>Insert the <b>TEST STRIP</b> to enter the Measuring Mode.</p>
	<p><b>Memory Mode:</b></p> <ol style="list-style-type: none"> <li>1. Review your blood glucose test results in the meter memory.</li> <li>2. Review your blood glucose day average results in the meter memory.</li> </ol>	<ol style="list-style-type: none"> <li>1. With the meter off, press and release <b>M</b> to enter the Memory Mode.</li> <li>2. When “” appears on the display, keep pressing <b>M</b> for 3 seconds until the flashing “<b>DAY AVG</b>” appears.</li> </ol>
	<p><b>Communication Mode:</b> Download your blood glucose test results onto the computer.</p>	<p>With the meter off, connect the <b>CABLE</b> to enter the Communication Mode.</p>

## Test Strip

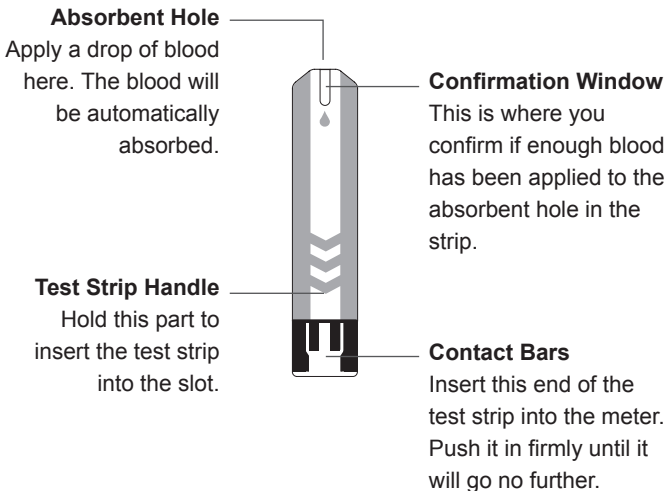

### ATTENTION:

**The front side of test strip should face up when inserting test strip.**

Test results might be wrong if the contact bar is not fully inserted into the test slot.

### NOTE:

The **PLUS Talking** monitor should only be used with **PLUS Test Strips**. Using other test strips with this meter can produce inaccurate results.

# SETTING THE METER

Before using your meter for the first time or if you change the meter battery, you should check and update these settings. Make sure you complete the steps below and have your desired settings saved.



## Entering the Setting Mode

Start with the meter off (no test strip inserted). Press **SET**.

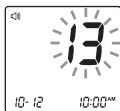

### 1. Setting the date

With the YEAR flashing, press **M** until the correct year appears. Press **SET**.



[ DD / MM ]

With the MONTH flashing, press **M** until the correct month appears. Press **SET**.

With the DAY flashing, press **M** until the correct day appears. Press **SET**.

(i.e. the date setting sequence shown left is MM (10) with flashing first and DD (18) later. The date display is October 18th. This conventional usage for date display is for **EU**.)



[ MM/DD ]

With the MONTH flashing, press **M** until the correct month appears. Press **SET**.

With the DAY flashing, press **M** until the correct day appears. Press **SET**.

(i.e. the date setting sequence shown left is MM (10) with flashing first and DD (18) later. The date display is October 18th. This conventional usage for date display is for **US**.)

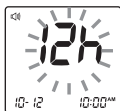

[ 12 hr ]



[ 24 hr ]

## 2. Setting the time format

Press **M** to select the desired time format --- 12h or 24h. Press **SET**.

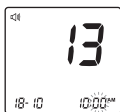
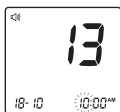

## 3. Setting the time

With the HOUR flashing, press **M** until the correct hour appears. Press **SET**.

With the MINUTE flashing, press **M** until the correct minute appears. Press **SET**.

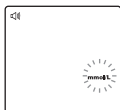

## 4. Setting the unit of measurement

Press **M** to switch between mg/dL and mmol/L. Press **SET**.

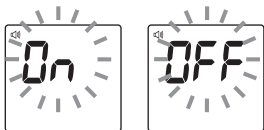

## 5. Setting the Buzzer

With the buzzer displays, press **M** to switch between “On” and “OFF”. Press **SET**.

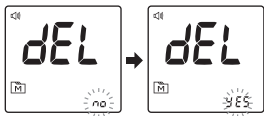

## 6. Deleting the memory

With “dEL” and a flashing “**M**” on the display, press **M** and select “no” to keep the results in memory then press **SET** to skip.

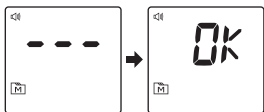



To delete all the results, press **M** and select “yes” to delete all the memory records.



## 7. Setting the speaking volume

There are seven (7) speaking volume options to choose from. Press **M** until the desired speaking volume appears. To confirm your selection, press **SET**.

Volume 0 indicates that the speaking function is turned off, and “” will not display during testing. Volume 1 to 7 indicates speaking volume from low to high, and “” will be displayed throughout the testing.





## 8. Choosing a language

Press **M** to select L1/L2. The default language for the meter is L1, which is English. To confirm your selection, press **SET**.

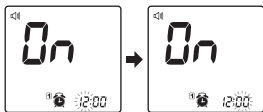
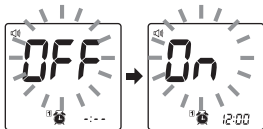

## 9. Setting the reminder alarm

Your meter has four reminder alarms. The meter will display “OFF” and “”. If you don’t want to set an alarm, press **SET** to skip this step. Or press **M** to select “On”, then press **SET**.

With the hour flashing, press **M** to select the correct hour. Press **SET**.

With the minute flashing, press **M** to select the correct minute. Press **SET** to confirm and go to the next alarm setting.

### NOTICE:

When the alarm beeping, there are three ways to do.

- 1) Press **M** to silence it and start your test.
- 2) Press and Hold **M** to switch off the meter.
- 3) If you do not do anything, the meter will beep for 2 minutes then switch it off.

If you have already set an alarm, and you want to turn it off. Press **SET** to find the alarm number, then Press **M** to change from “On” to “OFF”.

**Congratulations! You have completed all settings!**

**NOTE:**

- These parameters can **ONLY be changed** in the setting mode.
- If the meter is idle for 3 minutes during the setting mode, it will switch off automatically.

# THE FOUR MEASURING MODES

The meter provides you with four modes for measuring, General, AC, PC and QC.

MODES	USE WHEN
General (displays as “Gen”)	any time of day without regard to time since last meal
AC	no food intake for at least 8 hours
PC	2 hours after a meal
QC	testing with the control solution

You can switch between each mode by:

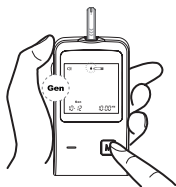

1. Start with the meter switched off. Insert a test strip to turn on the meter. The screen will display a flashing “” and “Gen”.

## Voice Guide

Thank you for using this product.  
Please relax during measurement.  
Please apply blood onto the strip.

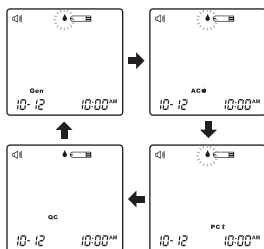

2. Press **M** to switch between General, AC, PC and QC mode.

# BEFORE TESTING

## Quality Control Testing Testing

### When should the control solution test be performed?:

- if it is mandatory following the local regulations in your country,
- if you suspect the meter or test strips are not working properly,
- if your blood glucose test results are not consistent with how you feel, or if you think the results are not accurate,
- to practice the testing process, or
- if you have dropped or think you may have damaged the meter.

Test strips, control solutions, or sterile lancets may not be included in the kit (please check the contents on your product box). They can be purchased separately. Please make sure you have those items needed for a blood glucose test beforehand.

## Performing a Control Solution Test

You will need:

1 **Meter**



2 **Test Strip**





3 **Control Solution**





## 1. Insert the test strip to turn on the meter

Insert the test strip into the meter. Wait for the meter to display “” and “”.

### Voice Guide

Thank you for using this product.  
Please relax during measurement.  
Please apply blood onto the strip.

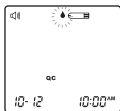

## 2. Press **M** to mark this test as a control solution test

With “**QC**” displayed, the meter will store your test result in memory under “**QC**”. If you press the **M** again, the “**QC**” will disappear and this test is no longer a control solution test.

### WARNING:

When doing the control solution test, you have to mark it so that the test result will **NOT** mix with the blood glucose **TEST RESULTS** stored in the memory. Failure to do so will mix up the blood glucose test results with the control solution test results in memory.

### 3. Apply control solution

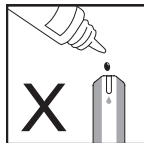
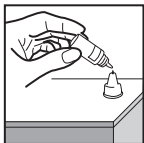

Shake the control solution vial thoroughly before use. Squeeze out the first drop and wipe it off, then squeeze out another drop and place it on the tip of the vial cap. Hold the meter to move the absorbent hole of the test strip to touch the drop. Once the confirmation window fills completely, the meter will begin counting down.

#### NOTICE:

To avoid contaminating the control solution, do not directly apply control solution onto a strip.

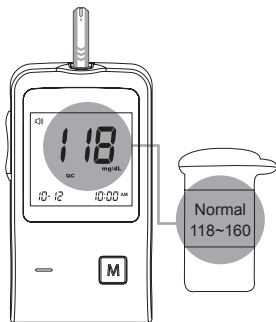

### 4. Read and compare the result

After counting down to 0, the control solution test result will appear on the display. Compare this result with the range printed on the test strip vial and it should fall within this range. If not, please read the instructions again and repeat the control solution test. (118 mg/dL = 6.5 mmol/L; 118–160 mg/dL = 6.5–8.8 mmol/L)

#### Voice Guide

Your blood glucose is (number) milligrams per deciliter.

## Out-of-range results

If you continue to have test results fall outside the range printed on the test strip vial, the meter and strips may not be working properly. Do **NOT** test your blood. Contact the local customer service or place of purchase for help.

### NOTE:

- The control solution range printed on the test strip vial is for control solution use only. It is not a recommended range for your blood glucose level.
- See the **MAINTENANCE** section for important information about your control solutions.

# TESTING WITH BLOOD SAMPLE

## **WARNING:**

To reduce the chance of infection:

- Never share a lancet or the lancing device.
- Always use a new, sterile lancet. Lancets are for single use only.
- Avoid getting hand lotion, oils, dirt, or debris in or on the lancets and the lancing device.

## **Preparing the Lancing Device for Blood Testing**

Please follow the instructions in the lancing device insert for collecting a blood sample.

## **Preparing the Puncture Site**

Stimulating blood perfusion by rubbing the puncture site before blood extraction has a significant influence on the glucose value obtained. Blood from a site that has not been rubbed exhibits a measurably different glucose concentration than blood from the finger. When the puncture site was rubbed prior to blood extraction, the difference was significantly reduced.

**Please follow the suggestions below before obtaining a drop of blood:**

- **Wash and dry your hands before starting.**
- Select the puncture site either at fingertips or another body parts (please see section “Alternative Site Testing” (AST) on how to select the appropriate sites).



- Rub the puncture site for about 20 seconds before penetration.
- Clean the puncture site using cotton moistened with 70% alcohol and **let it air dry**.
- Use a clear cap (included in the kit) while setting up the lancing device.



### • Fingertip testing

Press the lancing device's tip firmly against the lower side of your fingertip. Press the release button to prick your finger, then a click indicates that the puncture is complete.

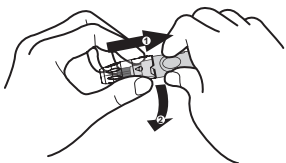

### • Blood from sites other than the fingertip

Replace the lancing device cap with the clear cap for AST. Pull the cocking control back until it clicks. When lancing the forearm, upper arm, or hand, avoid lancing the areas with obvious veins because of excessive bleeding.

#### NOTE:

- Choose a different spot each time you test. Repeated punctures at the same spot may cause soreness and calluses.
- Please consult your health care professional before you begin AST.
- It is recommended that you discard the first drop of blood as it might contain tissue fluid, which may affect the test result.

# Performing a Blood Glucose Test

You will need:

**1 Meter**



**2 Test Strip**





**3 Lancing Device**

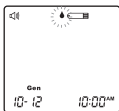

**4 Lancet**

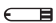

**1. Insert the test strip to turn on the meter**

Wait for the meter to display “” and “”.

 **Voice Guide**

Thank you for using this product.  
Please relax during measurement.  
Please apply blood onto the strip.

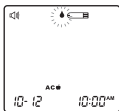
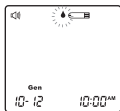

**2. Select the appropriate measuring mode by pressing .**

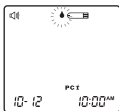
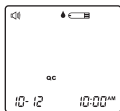

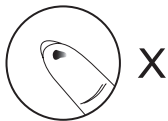

### 3. Obtaining a blood sample

Use the pre-set lancing device to puncture the desired site. The size of the drop should be at least as big as  (actual size), which is **0.5** microliter ( $\mu\text{L}$ ) of volume. Gently squeeze the punctured area to obtain another drop of blood. Be careful **NOT** to smear the blood sample.

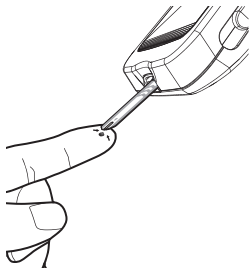

### 4. Apply the sample

Gently apply the drop of blood to the absorbent hole of the test strip at a titled angle. Confirmation window should be completely filled if enough blood sample has been applied. Do **NOT** remove your finger until you hear a beep sound.



## NOTE:

- Do not press the punctured site against the test strip or try to smear the blood.
- If you do not apply a blood sample to the test strip within 3 minutes, the meter will automatically turn off. You must remove and reinsert the test strip to start a new test.
- The confirmation window should be filled with blood before the meter begins to count down. **NEVER** try to add more blood to the test strip after the drop of blood has moved away. **Discard the used test strip and retest with a new one.**
- If you have trouble filling the confirmation window, please contact your health care professional or the local customer service for assistance.



## 5. Read your result

The result of your blood glucose test will appear after the meter counts down to 0. The blood glucose result will be stored in the memory automatically (100 mg/dL = 5.5 mmol/L)



### Voice Guide

Your blood glucose is (number) milligrams per deciliter.

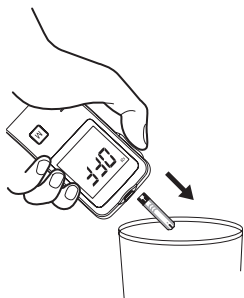

## 6. Eject the used test strip

Eject the test strip by pushing the eject button on the side. Use a sharp bin to dispose of used test strips. The meter will switch itself off automatically.

**Always follow the instructions in the lancing device insert when removing the lancet.**

### **WARNING:**

The used lancet and test strip may be biohazardous. Please discard them carefully according to your local regulations.

## Alternative Site Testing

You can test on a variety of locations on your body.

**Important:**

**There are limitations with AST (Alternative Site Testing).**

**Please consult your health care professional before you perform AST.**

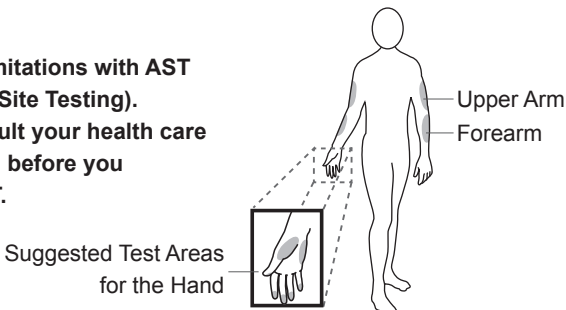

### When to use AST?

Food, medication, illness, stress and exercise can affect blood glucose levels. Capillary blood at the fingertip reflects these changes faster than capillary blood at other sites. Thus, when testing blood glucose during or immediately after a meal, physical exercise, or any other event, **take a blood sample from your finger only.**

We strongly recommend that you perform AST **ONLY** at the following times:

- In a pre-meal or fasting state (more than 2 hours since the last meal).
- Two hours or more after taking insulin.
- Two hours or more after exercise.

Do **NOT** use AST if:

- You think your blood glucose is low.
- You are unaware of hypoglycemia.
- You are testing for hyperglycemia.
- Your AST results do not match the way you feel.
- Your routine glucose results often fluctuate.

# METER MEMORY

The meter stores the **450** most recent blood glucose test results along with respective dates and times in its memory. To enter the meter memory, **start with the meter switched off.**

## Reviewing Test Results

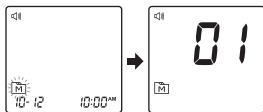

**1. Press and release **M**.** “**M**” will appear on the display. Press **M** again, and the first reading you see is the last blood glucose result along with date, time and the measuring mode.

(120 mg/dL = 6.6 mmol/L)



### **Voice Guide**

Your blood glucose is (number) milligrams per deciliter.

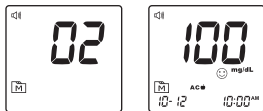

**2. Press **M**** to recall the test results stored in the meter each time you press.

**After the last test result, press **M** again and the meter will be turned off.**

(100 mg/dL = 5.5 mmol/L)

### **Voice Guide**

Your blood glucose is (number) milligrams per deciliter.

# Reviewing Blood Glucose Day Average Results

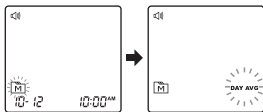

**1. Press and release **M**.** When “**M**” appears on the display, keep pressing **M** for 3 seconds until the flashing “**DAY AVG**” appears. Release **M** and then your 7-day average result measured in general mode will appear on the display.  
(100mg/dL =5.5 mmol/L)

**2. Press **M** to review 14-, 21-, 28-, 60- and 90- day average results** stored in each measuring mode in the order of Gen, AC, then PC.

**3. Exit the meter memory.** Keep pressing the **M** and the meter will turn off after displaying the last test result.

## NOTE:

- Any time you wish to exit the memory, keep pressing **M** for 5 seconds or leave it without any action for 3 minutes. The meter will switch off automatically.
- Control solution results are **NOT** included in the day average.
- If using the meter for the first time, “---” displays when you recall the test results or review the average result. It indicates that there is no test result in the memory.



# DOWNLOADING RESULTS ONTO A COMPUTER

## Data Transmission Via Cable

You can use the meter with a RS232 interface cable and the Health Care Software System to view test results on your personal computer. To learn more about the Health Care Software System or to obtain a RS232 interface cable separately, please contact the local customer services or place of purchase for assistance.

### 1. Obtaining the required cable and installing the software

To download Health Care Software System, please visit the TaiDoc's website: [www.taidoc.com](http://www.taidoc.com)

### 2. Connecting to a personal computer

Connect the cable to a RS232 port on your computer. With the meter switched off, connect the other end of the interface cable to the meter data port. "PC" will appear on the meter display, indicating that the meter is in communication mode.

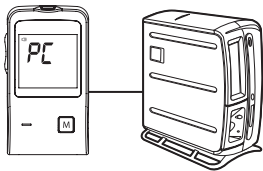

### 3. Data transmission

To transmit data, follow the instructions provided with the software. Results will be transmitted with date and time. Remove the cable and the meter will automatically switch off.

#### **WARNING:**

While the meter is connecting to the PC, it will be unable to perform a blood glucose test.

# MAINTENANCE

## Battery

Your meter comes with two 1.5V AAA size alkaline batteries.

### Low Battery Signal

The meter will display one of the messages below to alert you when the meter power is getting low.

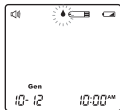

1. The “” symbol appears along with display messages: The meter is functional and the result remains accurate, but it is time to change the batteries.



2. The “” symbol appears with **E-b, Error and low**: The power is not enough to do a test. Please change the batteries immediately.

### Replacing the Battery

To replace the batteries, make sure the meter is turned off.

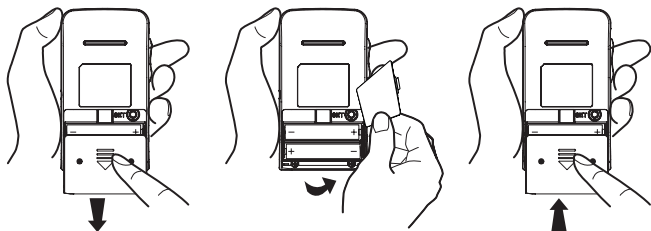

1. Press the edge of the battery cover and lift it up to remove.
2. Remove the old batteries and replace with two 1.5V AAA size alkaline batteries.
3. Close the battery cover. If the batteries are inserted correctly, you will hear a “beep” afterwards.

**NOTE:**

- Replacing the batteries does not affect the test results stored in the memory.
- As with all small batteries, these batteries should be kept away from children. If swallowed, promptly seek medical assistance.
- Batteries might leak chemicals if unused for a long time. Remove the batteries if you are not going to use the device for an extended period (i.e., 3 months or more).
- Properly dispose of the batteries according to your local environmental regulations.

## Caring for Your Meter

To avoid the meter and test strips attracting dirt, dust or other contaminants, please wash and dry your hands thoroughly before use.

### Cleaning

- To clean the meter exterior, wipe it with a cloth moistened with tap water or a mild cleaning agent, then dry the device with a soft dry cloth. Do **NOT** rinse with water.
- Do **NOT** use organic solvents to clean the meter.

### Meter Storage

- Storage conditions: -20°C to 60°C (-4°F to 140°F), 10% - 95% relative humidity.
- Always store or transport the meter in its original storage case.
- Avoid dropping and heavy impact.
- Avoid direct sunlight and high humidity.

### Meter Disposal

The used meter should be treated as contaminated that may carry a risk of infection during measurement. The batteries in this used meter should be removed and the meter should be disposed in accordance with local regulations.

The meter falls outside the scope of the European Directive 2002/96/EC-Directive on waste electrical and electronic equipment (WEEE).

## Caring for Your Test Strips

- Storage conditions: 2°C to 30°C (35.6°F to 86°F), 10% - 85% relative humidity. Do **NOT** freeze.
- Store your test strips in their original vial only. Do not transfer to another container.
- Store test strip packages in a cool dry place. Keep away from direct sunlight and heat.
- After removing a test strip from the vial, immediately close the vial cap tightly.
- Touch the test strip with clean and dry hands.
- Use each test strip immediately after removing it from the vial.
- Write the opening date on the vial label when you first opened it. Discard remaining test strips after 3 months.
- Do not use test strips beyond the expiry date. This may cause inaccurate results.
- Do not bend, cut, or alter a test strip in any way.
- Keep the strip vial away from children since the cap and the test strip may be a choking hazard. If swallowed, promptly see a doctor for help.

For further information, please refer to the test strip package insert.

## Important Control Solution Information

- Use only our control solutions with your meter.
- Do not use the control solution beyond the expiry date or 3 months after first opening. Write the opening date on the control solution vial and discard the remaining solution after 3 months.
- It is recommended that the control solution test be done at room temperature 20°C to 25°C (68°F to 77°F). Make sure your control solution, meter, and test strips are at this specified temperature range before testing.
- Shake the vial before use, discard the first drop of control solution, and wipe off the dispenser tip to ensure a pure sample and an accurate result.
- Store the control solution tightly closed at temperatures between 2°C to 30°C (35.6°F to 86°F). Do **NOT** freeze.

# SYSTEM TROUBLESHOOTING

If you follow the recommended action but the problem persists, or error messages other than the ones below appear, please call your local customer service. Do not attempt to repair yourself and never try to disassemble the meter under any circumstances.

## Result Readings

MESSAGE	WHAT IT MEANS		
<b>Lo</b>	< 20 mg/dL (1.1 mmol/L)		
<b>Low</b> ☹️	20–69 mg/dL (1.1–3.8 mmol/L)		
😊	<b>AC</b> 🍏	<b>PC</b> 🍷	<b>Gen</b>
	70–129 mg/dL (3.8–7.1 mmol/L)	70–179 mg/dL (3.8–9.9 mmol/L)	70–119 mg/dL (3.8–6.6 mmol/L)
<b>HIGH</b> ☹️	<b>AC</b> 🍏	<b>PC</b> 🍷	<b>Gen</b>
	130–239 mg/dL (7.2–13.2 mmol/L)	180–239 mg/dL (10–13.2 mmol/L)	120–239 mg/dL (6.6–13.2 mmol/L)
<b>KETONE?</b> <b>HIGH</b> ☹️	≥ 240 mg/dL (13.3 mmol/L)		
<b>H<sub>i</sub></b>	> 600 mg/dL (33.3 mmol/L)		

## Error Messages

MESSAGE	WHAT IT MEANS	WHAT TO DO
E-b	Appears when the batteries are too low.	Replace the batteries immediately.
E-U	Appears when a used test strip is inserted.	Repeat with a new test strip.
E-t	Appears when ambient temperature is above or below system operation range.	System operation range is 10°C to 40°C (50°F to 104°F). Repeat the test after the meter and test strip are in the above temperature range.
E-0, E-A, E-C	Problem with the meter.	Repeat the test with a new test strip. If the meter still does not work, please contact the customer service for assistance.
E-F	Appears when test strip is removed while counting down, or insufficient blood volume.	Review the instructions and repeat test with a new strip. If the problem persists, please contact the local customer service for help.
E-E	Appears when the calibration data is not correct.	Please contact local customer service for help.
E-3	Problem with the voice chip.	Please contact local customer service for help.



## Troubleshooting

1. If the meter does not display a message after inserting a test strip:

POSSIBLE CAUSE	WHAT TO DO
Batteries exhausted.	Replace the batteries.
Test strip inserted upside down or incompletely.	Insert the test strip with contact bars end first and facing up.
Defective meter or test strips.	Please contact customer services.

2. If the test does not start after applying the sample:

POSSIBLE CAUSE	WHAT TO DO
Insufficient blood sample.	Repeat the test using a new test strip with larger volume of blood sample.
Defective test strip.	Repeat the test with a new test strip.
Sample applied after automatic switch-off (3 minutes after last user action).	Repeat the test with a new test strip. Apply sample only when flashing “  <p>3. If the control solution testing result is out of range:</p>

POSSIBLE CAUSE	WHAT TO DO
Error in performing the test.	Read instructions thoroughly and repeat the test again.
Control solution vial was poorly shaken.	Shake the control solution vigorously and repeat the test again.
Expired or contaminated control solution.	Check the expiry date of the control solution.
Control solution that is too warm or too cold.	Control solution, meter, and test strips should be at room temperature 20°C to 25°C ( 68°F to 77°F) before testing.
Defective test strip.	Repeat the test with a new test strip.
Meter malfunction.	Please contact customer services.

# DETAILED INFORMATION







The meter provides you with plasma equivalent results.





Time of day	Normal plasma glucose range for people <b>without</b> diabetes (mg/dL)
Fasting and before meal	< 100 mg/dL (5.6 mmol/L)
2 hours after meals	< 140 mg/dL (7.8 mmol/L)

Source: American Diabetes Association. Standards of medical care in diabetes- 2016; 39 (supp.1 Diabetes Care): S16.

**Please consult your doctor to determine a target range that works best for you.**

# SYMBOL INFORMATION

SYMBOL	REFERENT
	<i>In vitro</i> diagnostic medical device
	Consult instructions for use
	Temperature limitation
	Use by
	Batch code
	Humidity limitation
	Caution, consult accompanying documents

SYMBOL	REFERENT
	Manufacturer
	Serial number
	CE mark
	Collection for electrical and electronic equipment
	Authorized representative in the European Community

# SPECIFICATIONS

**Model No.:** PLUS Talking

**Dimension & Weight:** 95 (L) x 52 (W) x 20 (H) mm, 48.8 g

**Power Source:** Two 1.5V AAA alkaline batteries

**Display:** LCD

**Memory:** 450 measurement results with respective date and time

**External Output:** RS232 PC interface

Auto electrode insertion detection

Auto sample loading detection

Auto reaction time count-down

Auto switch-off after 3 minutes without action

Temperature Warning

## **Operating Condition:**

10°C to 40°C (50°F to 104°F), 10% - 85% R.H. (non-condensing)

## **Meter Storage / Transportation Conditions:**

-20°C to 60°C (-4°F to 140°F), 10% - 95% R.H.

## **Strip Storage / Transportation Conditions:**

2°C to 30°C (35.6°F to 86.0°F), 10% - 85% R.H.

**Measurement Units:** either mg/dL or mmol/L

**Measurement Range:** 20 to 600mg/dL (1.1 to 33.3mmol/L)

This device has been tested to meet the electrical and safety requirements of:  
IEC/EN 61010-1, IEC/EN 61010-2-101, IEC/EN 61326-1, IEC/EN 61326-2-6.





## TERMS & CONDITIONS OF WARRANTY

1. We warrant this product to be free of defects in workmanship and materials within the said warranty period on the warranty certificate.
2. During the warranty period, if this product is found to be defective, you may bring it, together with the purchase receipt and Warranty Certificate, on a carry-in basis to our office during normal business hours for warranty service. We will then repair or replace defective parts or exchanging the whole product as we may choose, at no charge to the original owner. After such repair, replacement or exchange, the product will be warranted for up to the remainder of the warranty period.
3. This warranty is valid only if the Warranty Certificate and Warranty Registration Card are duly completed with date of purchase, serial number and dealer's stamp, and if the Warranty Registration Card is sent to our office not later than 14 days from the date of purchase.
4. This warranty is void if this product has been repaired or serviced by unauthorized person. This warranty does not cover defects caused by misuse, abuse, accident, tampering, lack of reasonable care, fire or any other acts beyond human control.
5. Except as stated in the above paragraphs, we disclaim all other warranties, implied or expressed, including the warranties of merchantability or fitness for a particular purpose with respect to the use of this product. We shall not be liable for any direct, consequential or incidental damages arising out of the use or inability to use this product.

Owner's Portion

# WARRANTY CERTIFICATE

YEAR  
WARRANTY

Name of Product

---

Name of Owner

---

Address

---

Tel No. (Mobile)

(H)

(O)

---

Email

Age

Gender

M

F

Date of Purchase

/  /

day

month

year

Dealer's Stamp

Serial No. \_\_\_\_\_

**NOTE:** Please produce this card together with the purchase receipt for warranty service.



# WARRANTY REGISTRATION CARD

Owner's Portion

Name of Product \_\_\_\_\_

Name of Owner \_\_\_\_\_

Address \_\_\_\_\_

Tel No. (Mobile) \_\_\_\_\_

(H)

(O)

Email \_\_\_\_\_

Age

Gender

M

F

Date of Purchase  /  /   
day month year

Serial No. \_\_\_\_\_

Dealer's Stamp

**IMPORTANT:** To qualify for the warranty, please fill this card and mail to us 14 days from the date of purchase.

PLACE  
STAMP  
HERE

# DEALER'S INFORMATION



 **TaiDoc Technology Corporation**

B1-7F, No. 127, Wugong 2nd Rd., Wugu Dist.,  
24888 New Taipei City, Taiwan  
[www.taidoc.com](http://www.taidoc.com)

 **MedNet GmbH**

Borkstraße 10, 48163 Münster, Germany

For self-testing  
  